

1793 3rd Ave. East

Hand-drawn site plan for a proposed dwelling. The plan shows a rectangular building labeled "proposed dwelling" with dimensions 17.1m by 7.70m. It is situated on a lot with a total width of 13.683m and a depth of 41.147m. A 1.5m concrete sidewalk runs along the front boundary. To the right of the dwelling is a shed labeled "shed 11'x13'" and an asphalt area. A north arrow is located in the top left corner. Various survey points are marked: IB, SB, HP, BM, and CB. Dimensions for setbacks and building placement are provided throughout the plan.

3rd Avenue East - Grey rd. 15

Scale: 1:200

Approximate Setbacks

City block of 3rd Av. E. between 17th and 18th streets

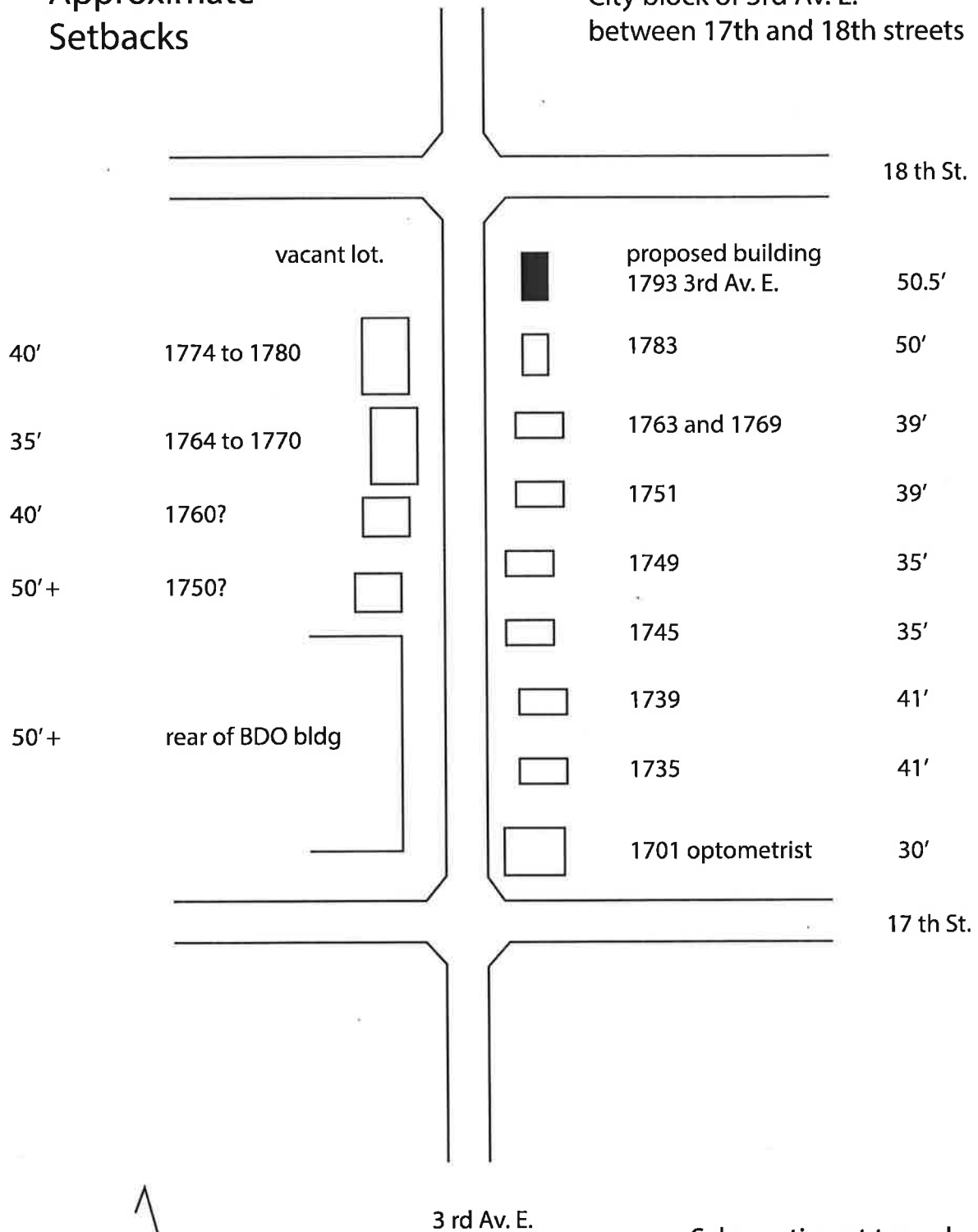

Schematic not to scale
Prepared by Joe Colucci
September 18, 2014