

Report CCR-PCD-15-15

To: Chair Wright and Members of the Planning and Community Development Committee

From: Petal Furness, Manager Grey Roots Museum and Archives

Meeting Date: July 21, 2015

Subject: **To request funding to complete the landscaping portion of the Grey Roots Logo Sculpture**

Status: Recommendation adopted by Committee as presented per Resolution PCD97-15; Endorsed by County Council August 4, 2015 per Resolution CC113-15;

Recommendation(s)

WHEREAS the steel sheaves of the Grey Roots logo sculpture were installed the fall of 2014 in front of the Grey Roots facility;

AND WHEREAS the final concrete pour, gravel and fill have been added to the base of the sculpture and the safety fencing removed;

AND WHEREAS it would be advantageous to finish the landscaping this year;

AND WHEREAS staff have developed a landscaping plan that could be completed this year within the 2015 capital budget;

NOW THEREFORE BE IT RESOLVED THAT Report CCR-PCD- 15 -15 regarding the completion of the landscaping for the logo sculpture be received;

AND THAT the plan to complete the logo sculpture at Grey Roots be approved as presented at an estimated cost of \$13,000;

AND FURTHER THAT the additional costs of the project be funded from savings within the capital budget being from savings in the first phase of sculpture and pre-engineering.

Background

The Planning and Community Development Committee adopted the recommendation to reallocate funds to complete the first phase of the installation of the Grey Roots Logo Sculpture in Report CCR-PCD-17-14. At that time three options were presented. The

Committee approved funding to get the sculpture erected and safe for the winter and staff was directed to come back with a plan to complete the structure.

The sheaves have been placed, the final concrete poured this spring when the danger of frost had passed, the gravel and dirt placed in the base and the fencing has been removed. Now that the structure is in place it is easier to imagine it finished. The original grandiose plan included a three dimensional map of Grey made out of cement. Also included in the original plan was LED lighting going up each sheaf of the logo.

Upon reflection this space feels very barren - a lot of cement on cement in front of a cement building. The entrance to Grey Roots is hot and windy in the summer, cold and blustery in the winter. It has been determined that it would be wonderful to have green, living plants on the south side of the sculpture to anchor it. A place to sit, reflect and rest would make the sculpture more welcoming so it is recommended to install a stone bench on all four sides of the sculpture. A water feature on the north side of the sculpture would be a soothing addition especially the sound of water trickling over large rocks and through old mill stones. Adding a water feature would be relatively inexpensive as the original plan called for water in the northern quadrant to represent Georgian Bay.

The colours contained in the Grey Roots logo represent: green = forests; grey = rocks; red = people; yellow = agriculture and blue = water. The logo integrates many of the concepts of the Interpretive Plan and symbolizes the stories and the strengths of the people of Grey County and their interaction with the elements.



View from parking lot.



South side plantings.

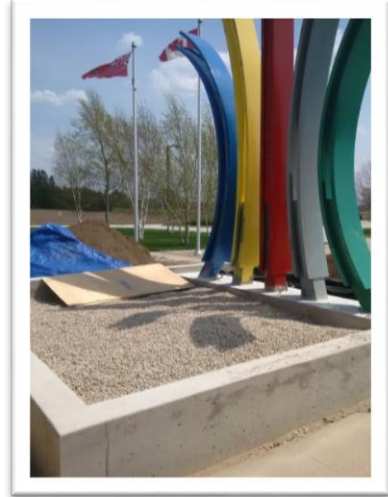

North side water feature.

To fully complete the project in 2015 with hardy green plants on the south side of the sculpture and a water feature with rocks and millstones on the north side, complete with a rock seating bench all 'round will cost approximately \$13,000. The sculpture as

originally proposed to the Committee last year would have cost an additional \$31,000 to finish.

Detail of Work	Base Cost	In-Kind	County Cost
Landscaping plants	2,500		2,500
Water feature materials	6,500		6,500
Electrical Wiring and receptacles	2,500	1,200	1,300
Stone Bench	2,500	1,000	1,500
Contingency	1,000		1,000
Subtotal	15,000	2,200	12,800
Non Rebatable share of HST			169
Total	15,000	2,200	12,969
Less: Savings in current capital budget for project carried forward from 2014 (forming)			(3,500)
Total Additional Requirements			9,469

Concept of proposed landscaping plan

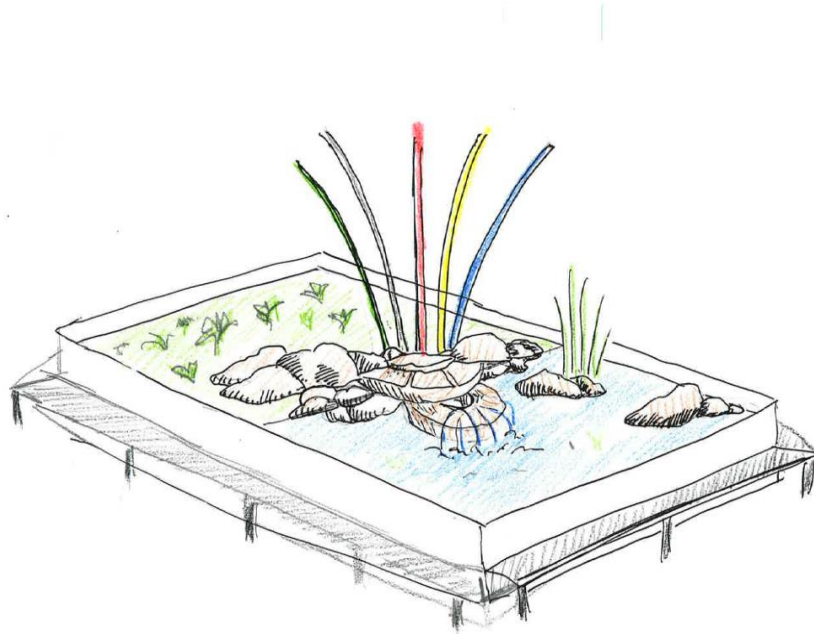

Financial / Staffing / Legal / Information Technology Considerations

The first phase of the sculpture as approved by Council was not completed in 2014 and the project was carried forward to the 2015 budget with \$9,800 allocated towards it. Currently it is anticipated that there will be savings of \$3,500 based on costs to date. It is recommended that the remaining additional cost of approximately \$9,500 to complete the project as outlined in this report be funded from savings in the pre-engineering line of the capital budget.

The costing of the landscaping materials and addition of a water feature is based on the lowest of three quotes received.

At this time staff do not recommend proceeding with the original plan to add the LED lighting which is estimated to cost \$1,500. It has been observed that there is plenty of backlighting from the building which allows people to see the sculpture at night. If there is a desire to pursue this lighting in the future, the necessary electrical requirements have already been installed.

There are no Legal or IT considerations arising from this report.

Staff, volunteers and visitors will feel this project is finally complete and all will be proud of the beauty the Grey Roots logo.

Link to Strategic Goals / Priorities

Goal 3.3 Championing arts, culture, and heritage initiatives.

Attachments: *None*

Respectfully submitted by,

Petal Furness
Manager, Grey Roots Museum and Archives

Director Sign Off: *Sharon Vokes*